

Rosa M. de la Camara
Shareholder
Board Certified Specialist, Condominium
and Planned Development Law
Phone: 305.260.1011 Fax: 305.442.2232
rdelacamara@beckerlawyers.com



Becker & Poliakoff
121 Alhambra Plaza
10th Floor
Coral Gables, FL 33134

September 10, 2021

Via Email: jpolasr@gmail.com

The Georgian Condominium Association, Inc.
c/o Board of Directors
Attn: Jorge Pola, President
1621 Collins Avenue
Miami Beach, FL 33139

Re: Recorded Supplementary Amendment

Dear Board:

We have not yet received the original copy of the recorded Supplementary Amendment back from the county clerk in the mail. However, we have been monitoring the website to see when this would get recorded. It is finally recorded.

Enclosed herein please find a copy of same. Please note that the Supplementary Amendment was recorded on 9/1/2021 and is deemed effective as of that date. The Association should provide a copy of the recorded Supplementary Amendment to all owners of record so that each owner's file will include a copy of the updated documents.

Should there be any questions or comments in this regard, please do not hesitate to give me a call.

Sincerely,

A handwritten signature in blue ink, appearing to read "Rosa M. de la Camara".

Rosa M. de la Camara
For the Firm

RMD/ma
Enclosure



CFN 2021R0650498
OR BK 32714 Pgs 4124-4163 (40Pgs)
RECORDED 09/01/2021 15:21:35
HARVEY RUVIN, CLERK OF COURT
MIAMI-DADE COUNTY, FLORIDA

This instrument was prepared by:
Rosa M. de la Camara, Esq.
Becker & Poliakoff, P.A.
121 Alhambra Plaza, 10th Floor
Coral Gables, Florida 33134

**SUPPLEMENTARY CERTIFICATE OF AMENDMENT
TO THE DECLARATION OF CONDOMINIUM
OF
THE GEORGIAN CONDOMINIUM ASSOCIATION, INC.**

WHEREAS, the Declaration of Condominium of The Georgian Condominium, was duly recorded in Official Records Book 10944 at Page 756 of the Public Records of Miami-Dade County, Florida; and

WHEREAS, the By-Laws and Articles of Incorporation of The Georgian Condominium Association, Inc. are attached as Exhibits thereto; and

WHEREAS, The Georgian Condominium Association, Inc. (hereinafter the "Association") is the entity responsible for the operation of the aforementioned condominium; and

WHEREAS, at a duly called and convened meeting of the membership of the Association held on December 7, 2020, the aforementioned Declaration, By-Laws and Articles of Incorporation were amended and restated pursuant to the provisions of said Declaration, By-Laws and Articles of Incorporation; and

WHEREAS, a Certificate of Amendment to the Declaration of Condominium of The Georgian Condominium and the By-Laws and Articles of Incorporation of The Georgian Condominium Association, Inc. recording the Amended and Restated Declaration, Amended and Restated By-Laws and Amended and Restated Articles of Incorporation, was duly recorded in the Public Records of Miami-Dade County, Florida on May 13, 2021, in Official Records Book 32506 at Page 2084; and

WHEREAS, Composite Exhibit A to the Amended and Restated Declaration of Condominium was inadvertently omitted when the documents were recorded; and

WHEREAS, The Georgian Condominium Association, Inc. hereby records this Supplementary Certificate of Amendment to record Composite Exhibit A.

NOW, THEREFORE, the undersigned hereby certify that the following Composite Exhibit A to the Amended and Restated Declaration, is a true and correct copy of the Exhibits attached to the Declaration when it was first recorded and are Composite Exhibit A to the Amended and Restated Declaration approved by the membership on December 7, 2020.

WITNESS my signature hereto this 23 day of July, 2021 in Miami-Dade County, Florida.

**THE GEORGIAN CONDOMINIUM
ASSOCIATION, INC.**

Martina Pelaez
Witness Signature
MARTHA PELAEZ
Print Name
Noemi Meila
Witness Signature
NOEMI MEILA
Print Name

BY: [Signature]
Jorge Pola, President

ATTEST: [Signature]
Patricia Nazar, Vice-President

Corporate Seal:

STATE OF FLORIDA
COUNTY OF MIAMI-DADE

The foregoing instrument was acknowledged before me by means of ☐ physical presence or ☐ online notarization this 23 day of July, 2021 by Jorge Pola, the President and Patricia Nazar, the Vice-President of The Georgian Condominium Association, Inc., a Florida not-for-profit corporation, on behalf of the corporation. Who are personally known to me or have produced () as identification and who did/did not take an oath.

My commission expires:

[Signature] (SEAL)
NOTARY PUBLIC SIGNATURE
STATE OF FLORIDA AT LARGE

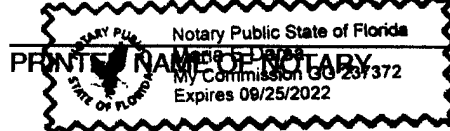

COMPOSITE EXHIBIT "A"
TO
AMENDED AND RESTATED DECLARATION OF CONDOMINIUM
PERCENTAGE OF OWNERSHIP OF COMMON ELEMENTS
AND
STATEMENT OF SURVEYOR AS TO LEGAL DESCRIPTION
OF
THE GEORGIAN CONDOMINIUM

PERCENTAGE OF OWNERSHIP OF COMMON ELEMENTS OF
THE GEORGIAN CONDOMINIUM

<u>TYPE A</u>	<u>Unit</u>	<u>Percentage</u>
	201	All Type A Units Are .7% Each.
	202	
	207	
	209	
	210	
	212	
	301	
	302	
	307	
	309	
	310	
	312	
	401	
	402	
	407	
	409	
	410	
	412	
	501	
	502	
	507	
	509	
	510	
	512	
	601	
	602	
	607	
	609	
	610	
	612	

(Continuation Percentage of Ownership of Common Elements Page Two)

701
702
707
709
710
712

801
802
807
809
810
812

901
902
907
909
910
912

PH. - 1001
PH. - 1002

TYPE B

Unit

Percentage

215	All Type B Units are .7% each.
315	
415	
515	
616	
715	
815	
915	
PH. - 1009	

(Continuation Percentage of Ownership of Common Elements Page Three)

<u>TYPE C</u>	<u>Unit</u>	<u>Percentage</u>
	204	All Type C Units are .5% each.
	208	
	214	
	304	
	308	
	314	
	404	
	408	
	414	
	504	
	508	
	514	
	604	
	608	
	614	
	704	
	708	
	714	
	804	
	808	
	814	
	904	
	908	
	914	

<u>TYPE D</u>	<u>Unit</u>	<u>Percentage</u>
	220	All Type D Units are .8% each.
	320	
	420	
	520	
	620	
	720	
	820	
	920	
	PH. - 1015	

(Continuation Percentage of Ownership of Common Elements Page Four)

<u>TYPE E</u>	<u>Unit</u>	<u>Percentage</u>
	203	All Type E Units are .6% each.
	205	
	211	
	303	
	305	
	311	
	403	
	405	
	411	
	503	
	505	
	511	
	603	
	605	
	611	
	703	
	705	
	711	
	803	
	805	
	811	
	903	
	905	
	911	
	PH. – 1003	

<u>TYPE F</u>	<u>Unit</u>	<u>Percentage</u>
	218	All Type F Units are .8% each.
	318	
	418	
	518	
	618	
	718	
	818	
	918	
	PH. – 1014	

(Continuation Percentage of Ownership of Common Elements Page Five)

<u>TYPE G</u>	<u>Unit</u>	<u>Percentage</u>
	206	All Type G Units are .6% each.
	216	
	306	
	316	
	406	
	416	
	506	
	516	
	606	
	616	
	706	
	716	
	806	
	816	
	906	
	916	

<u>TYPE H</u>	<u>Unit</u>	<u>Percentage</u>
	PH. – 1012	.8%

<u>TYPE I</u>	<u>Unit</u>	<u>Percentage</u>
	PH. – 1004	.7%

<u>TYPE J</u>	<u>Unit</u>	<u>Percentage</u>
	PH. – 1006	.7%

<u>TYPE K</u>	<u>Unit</u>	<u>Percentage</u>
	PH. – 1005	1.375%
	PH. – 1007	1.375%
	PH. – 1008	1.375%
	PH. – 1010	1.375%

REF 10944 PG 810

PAGE 66, which is the Plot Plan, is being recorded separately.

FULLER & FEINGOLD, P.A., ATTORNEYS AT LAW, PENTHOUSE 802, 111 LINCOLN ROAD MALL, MIAMI BEACH, FLORIDA 33139

Established 1936

Zurwelle-Whittaker, Inc.

CONSULTING ENGINEERS, SURVEYORS AND PLANNERS

924 Lincoln Mall
Miami Beach, Florida 33139

September 12, 1979

Telephones: 534
531

Fuller, Feingold, Weil & Scheer
802 Flagship Bank Bldg.
1111 Lincoln Road
Miami Beach, Florida 33139

Attention: Mr. Laurence Feingold

Re: Legal Descriptions of Georgian Condominium property.

THIS IS TO CERTIFY that the following two legal descriptions are one and the same, except for additional information added in the Zurwelle-Whittaker, Inc. survey description:

Abstract Legal - All that part of Block 55 bounded as follows: Beginning at a point at the Southwest corner of Lot 15, thence North along the West line of said Lot 15 and Lot 14, 100 feet to a point; thence East parallel to the South line of said Lot 15 to the East line of Lot 5, thence South along the East line of said Lot 5 and Lot 4 to the Southeast corner of Lot 4, thence West along the South line of Lot 4 and the South line of Lot 15 to the point of beginning; all being according to the plat of Fishers First Subdivision of Alton Beach, as recorded in Plat Book 2, Page 77 of the Public Records of Dade County, Florida;

ALSO - Beginning at the Southeast corner of Lot 4 of said Block 55, running in an Easterly direction along the South line of said Lot 4, produced to the high water line of the Atlantic Ocean, thence run in a Northerly direction meandering the said high water line, a distance of 100 feet, plus or minus; said point being at the intersection of said high water line, with a line parallel to the South line of said Lot 4 and 100 feet distant therefrom, thence Westerly parallel to the South line of said Lot 4 to a point on the Easterly line of Block 55, thence Southerly along the Easterly line of said Block 55, 100 feet to the point of beginning together with all riparian rights appurtenant and adjacent thereto.

Zurwelle-Whittaker, Inc. survey description - All that part of Block 55 bounded as follows: Beginning at a point at the Southwest corner of Lot 15, thence North along the West line of said Lot 15 and Lot 14, 100 feet Deed (Field 99.99 feet) to a point; thence East parallel to the South line of said Lot 15 to the East line of Lot 5, thence South along the East line of said Lot 5 and Lot 4 to the Southeast corner of Lot 4, thence West along the South line of Lot 4 and the South line of Lot 15 to the point of beginning; all being according to the plat of Fishers First Subdivision of Alton Beach, as recorded in Plat Book 2, Page 77 of the Public Records of Dade County, Florida.

Sheet 1 of 2

Established 1930

Zurwelle-Whittaker, Inc.

CONSULTING ENGINEERS, SURVEYORS AND PLANNERS

924 Lincoln Mall
Miami Beach, Florida 33139

September 12, 1979

Telephones: 534 4661
531 4581

Re: Legal Descriptions of Georgian Condominium property.

Zurwelle-Whittaker, Inc. survey description - (continued)

ALSO- Beginning at the Southeast corner of Lot 4 of said Block 55, running in an Easterly direction along the South line of said Lot 4, produce to the high water line of the Atlantic Ocean, thence run in a Northerly direction meandering the said high water line, a distance of 100 feet, plus or minus, said point being at the intersection of said high water line, with a line parallel to the South line of said Lot 4 and 100 feet distant therefrom, (or 98.60 feet as measured at 90° to the said South line of Lot 4); thence Westerly parallel to the South line of said Lot 4 to a point on the Easterly line of Block 55, thence Southerly along the Easterly line of said Block 55, 100 feet Deed (99.99 feet Field) to the point of beginning, together with all riparian rights appurtenant and adjacent thereto.

ZURWELLE-WHITTAKER, INC.

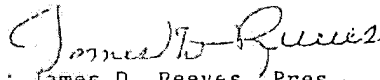
By: James D. Reeves, Pres.
P.L.S. No. 2194
State of Florida

JDR/cml

Sheet 2 of 2

10944 818

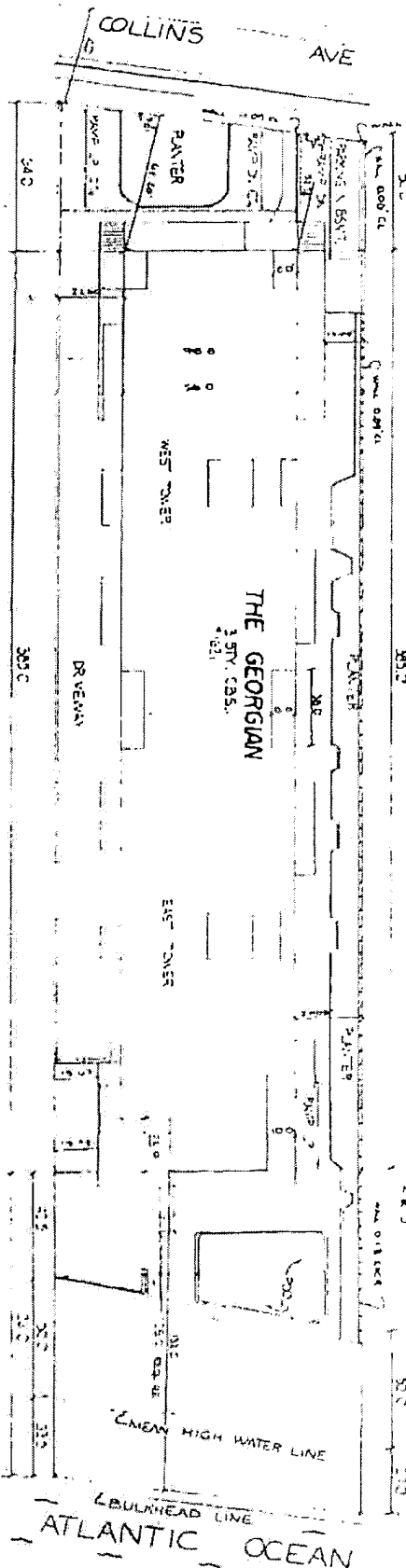

PLOT PLAN

LEGAL DESCRIPTION:

FOR LEGAL DESCRIPTION SEE SHEET 2 OF 29

SURVEYOR'S CERTIFICATE:

THE SURVEYOR HAS MADE THIS PLAN ON THE BASIS OF THE RECORDS OF THE SURVEYOR'S OFFICE AND THE RECORDS OF THE SURVEYOR'S OFFICE. THE SURVEYOR HAS MADE THIS PLAN ON THE BASIS OF THE RECORDS OF THE SURVEYOR'S OFFICE AND THE RECORDS OF THE SURVEYOR'S OFFICE. THE SURVEYOR HAS MADE THIS PLAN ON THE BASIS OF THE RECORDS OF THE SURVEYOR'S OFFICE AND THE RECORDS OF THE SURVEYOR'S OFFICE.

CEILING	12.03M
FLOOR	10.21M
1ST FL.	9.27M
2ND FL.	8.34M
3RD FL.	7.32M
4TH FL.	6.30M
5TH FL.	5.27M
6TH FL.	4.24M
7TH FL.	3.21M
8TH FL.	2.18M
9TH FL.	1.15M
10TH FL.	0.12M

ELEVATION PROFILE

NOTE: ELEVATIONS SHOWN ABOVE REFER TO 0.00' MEAN SEA LEVEL, U.S.C. 1929 DATUM PLANE

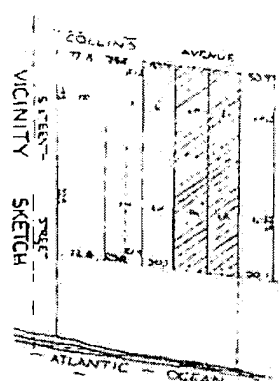

THE GEORGIAN CONDOMINIUM

DATE: OCT 13, 1980
REV: OCT 21, 1980
SHEET: OF 29

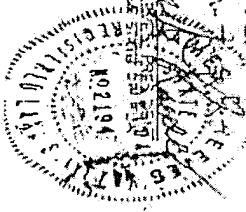

CLERK NOTE:
FOR DECLARATION OF CONDOMINIUM
SEE OFFICIAL RECORD BK. 10944 PG. 241

LEGAL DESCRIPTION
OF
THE GEORGIAN CONDOMINIUM

ALL THAT PART OF BLOCK 55 BOUNDED AS FOLLOWS:

BEGINNING AT A POINT AT THE SOUTHWEST CORNER OF LOT 15, THENCE NORTH ALONG THE WEST LINE OF SAID LOT 15 AND LOT 14, 100 FEET DEED (FIELD 99.99 FEET) TO A POINT;

THENCE EAST PARALLEL TO THE SOUTH LINE OF SAID LOT 15 TO THE EAST LINE OF LOT 5, THENCE SOUTH ALONG THE EAST LINE OF SAID LOT 5 AND LOT 4 TO THE SOUTHEAST CORNER OF LOT 4, THENCE WEST ALONG THE SOUTH LINE OF LOT 4 AND THE SOUTH LINE OF LOT 15 TO THE POINT OF BEGINNING; ALL BEING ACCORDING TO THE PLAT OF FISHERS FIRST SUBDIVISION OF ALTON BEACH, AS RECORDED IN PLAT BOOK 2, PAGE 77 OF THE PUBLIC RECORDS OF DADE COUNTY, FLORIDA.

ALSO

BEGINNING AT THE SOUTHEAST CORNER OF LOT 4 OF SAID BLOCK 55, RUNNING IN AN EASTERLY DIRECTION ALONG THE SOUTH LINE OF SAID LOT 4, PRODUCED TO THE HIGH WATER LINE OF THE ATLANTIC OCEAN, THENCE RUN IN A NORTHERLY DIRECTION MEANDERING THE SAID HIGH WATER LINE, A DISTANCE OF 100 FEET, PLUS OR MINUS, SAID POINT BEING AT THE INTERSECTION OF SAID HIGH WATER LINE, WITH A LINE PARALLEL TO THE SOUTH LINE OF SAID LOT 4 AND 100 FEET DISTANT THEREFROM, (OR 98.60 FEET AS MEASURED AT 90° TO THE SAID SOUTH LINE OF LOT 4); THENCE WESTERLY PARALLEL TO THE SOUTH LINE OF SAID LOT 4 TO A POINT ON THE EASTERLY LINE OF BLOCK 55, THENCE SOUTHERLY ALONG THE EASTERLY LINE OF SAID BLOCK 55, 100 FEET DEED (99.99 FEET FIELD) TO THE POINT OF BEGINNING, TOGETHER WITH ALL RIPARIAN RIGHTS APPURTENANT AND ADJACENT THERETO.

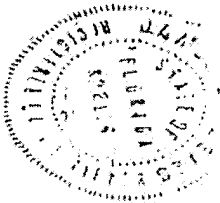

EXHIBIT "7" PLOT PLAN SURVEY & GRAPHIC DESCRIPTION

THE GEORGIAN CONDOMINIUM

Order No. 80-019
Zurwelle-Whittaker, Inc.
Consulting Engineers & Surveyors
Miami Beach, Florida

Date: Oct. 21, 1980

Sheet 2 of 29

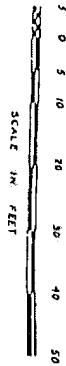

BASEMENT FLOOR PLAN
(WEST TOWER)

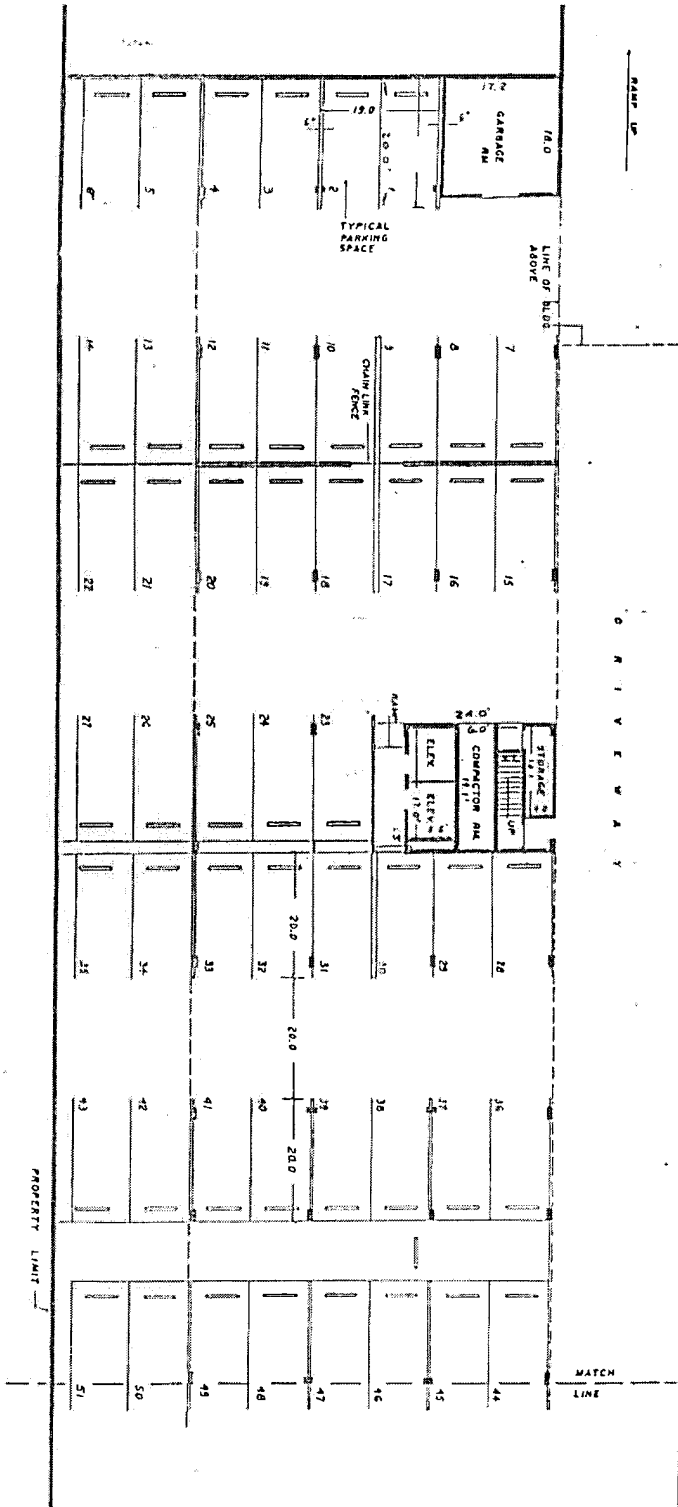

NOTE
NOT VALID UNLESS RAISED SEAL
OF JAMES D. REYES PLS AC 2-94
STATE OF FLORIDA IS AFFIXED

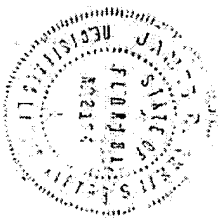
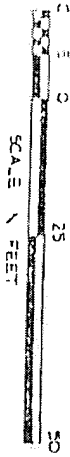
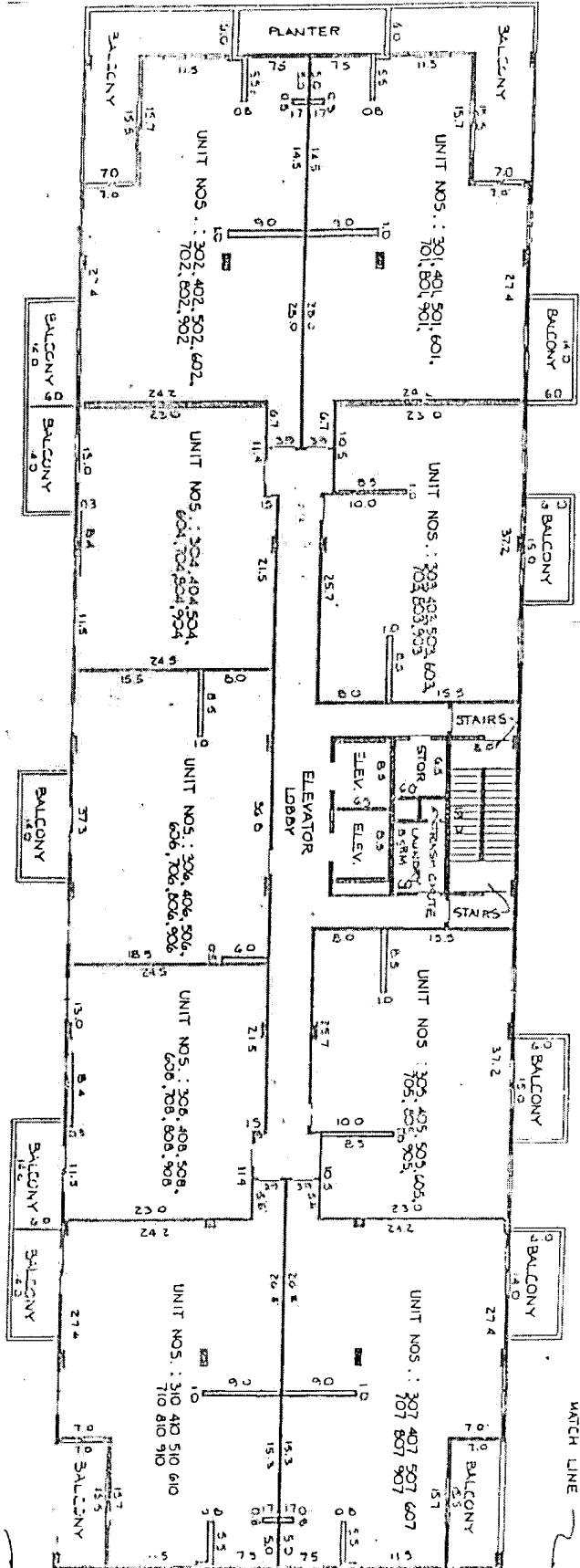

EXHIBIT 7' PLOT PLAN, SURVEY & GRAPHIC DESCRIPTION
THE GEORGIAN CONDOMINIUM
ORDER NO 80-019
JURWELLE WHITTAKER, INC.
CONSULTING ENGINEERS & SURVEYORS
DATE 10/17/80
REV 10/17/80
MICKI DEGEN FLSB0011



2011/01/25 JESS RASEN
WALTON, KESUN REYES, a.s
21254, LAMOU CORVA, a.s
211110



TYPICAL FLOOR PLAN

(WEST TOWER)

(4TH TRAIL FROM FLS.)

EXHIBIT 17, PLOT PLAN SURVEY & GRAPHIC DESCRIPTION
THE GEORGIAN CONDOMINIUM
ORDER NO. BD-0-9 DATE: 10/27/90
TURNER, WATKINS, INC. REV: 10/27/90
CONSULTING ENGINEERS & SURVEYORS
MIAMI BEACH, FLA. SHEET 10 OF 29

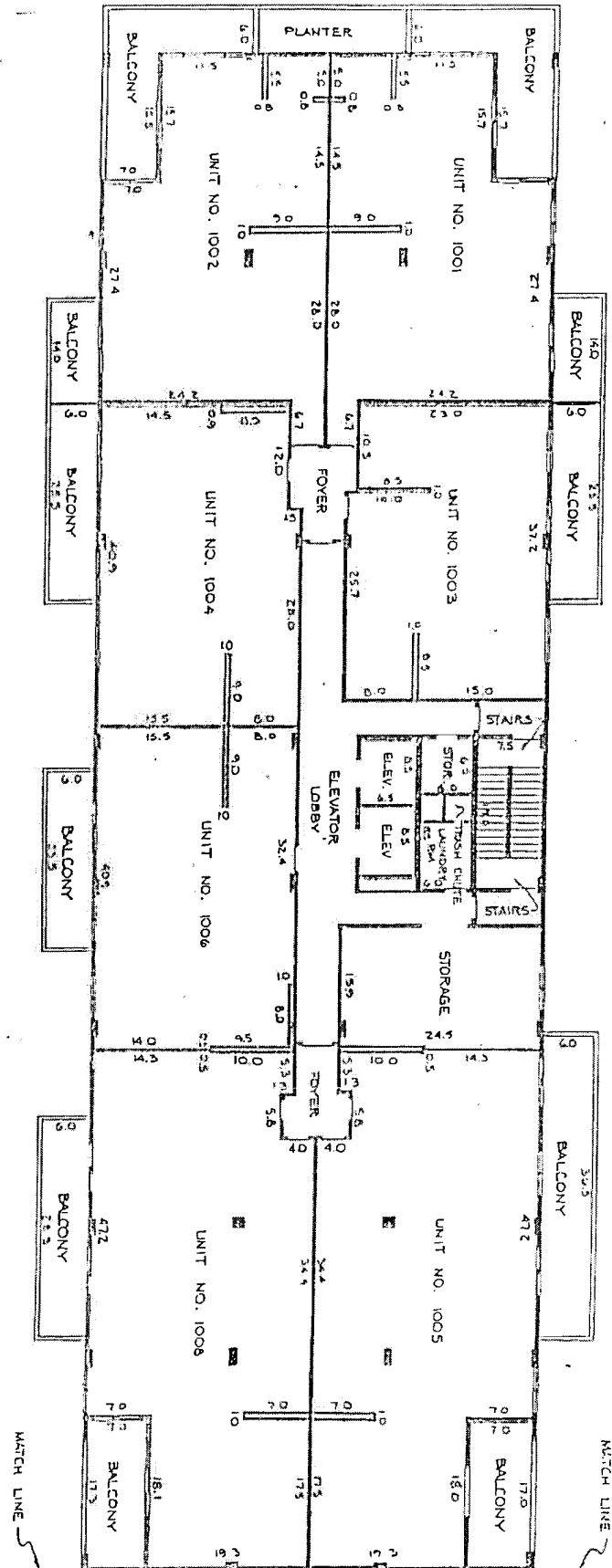

NOTE: NOT VALID UNLESS RAISED
SEAL OF JAMES D. REEVES, P.L.S.
NO. 2194, STATE OF FLORIDA IS
AFFIXED.

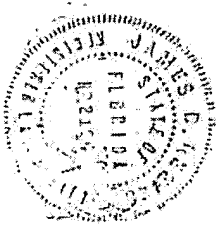

PENTHOUSE FLOOR PLAN (WEST TOWER)

EXHIBIT 7" PLOT PLAN SURVEY & GRAPHIC DESCRIPTION
THE GEORGIAN CONDOMINIUM
ORDER NO. BO-019
DATE: 10-13-80
ZURVELLE-WHITTAKER, INC.
CONSULTING ENGINEERS & SURVEYORS
MIAMI BEACH, FLA.
SHEET 12 OF 29

NOT
WIT. AND UNLESS PAISED SEAL
ON JAMES D. REEVES HAS NO PWR
STATE OF FLORIDA IS AFFRID

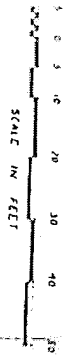

LOBBY FLOOR PLAN (EAST TOWER)

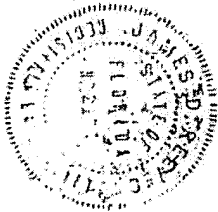
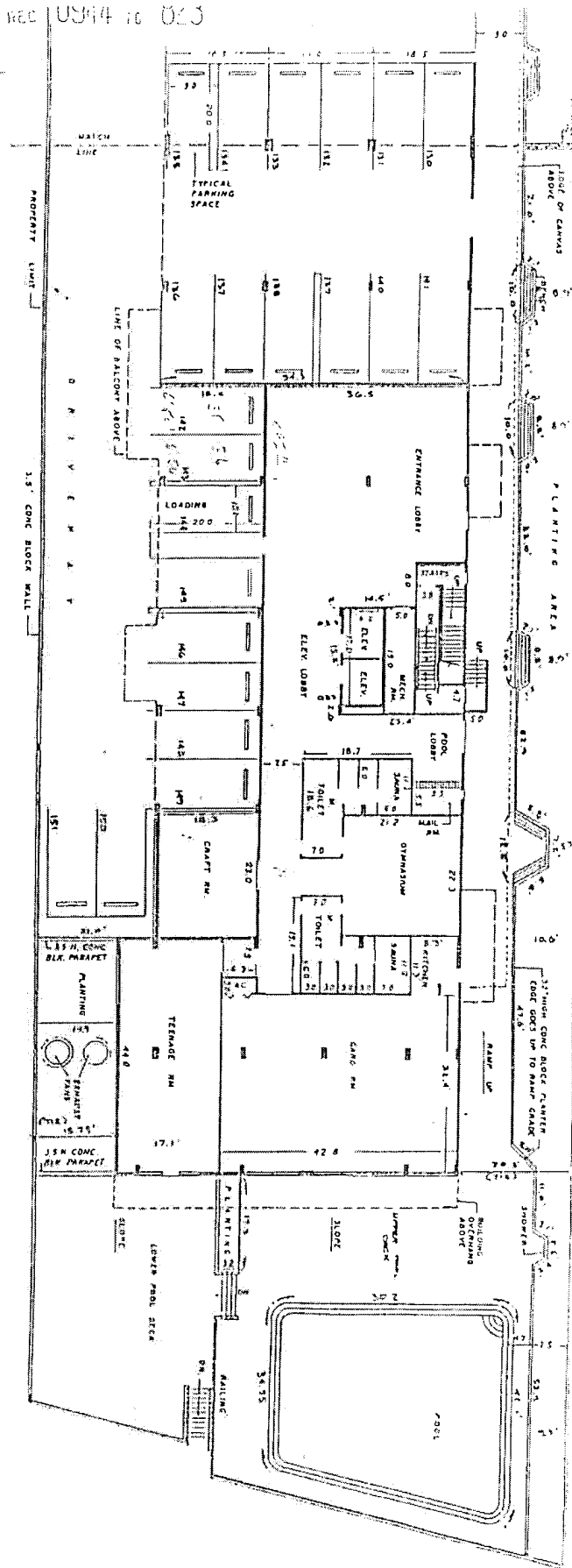
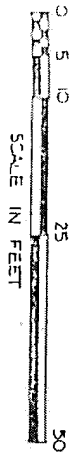
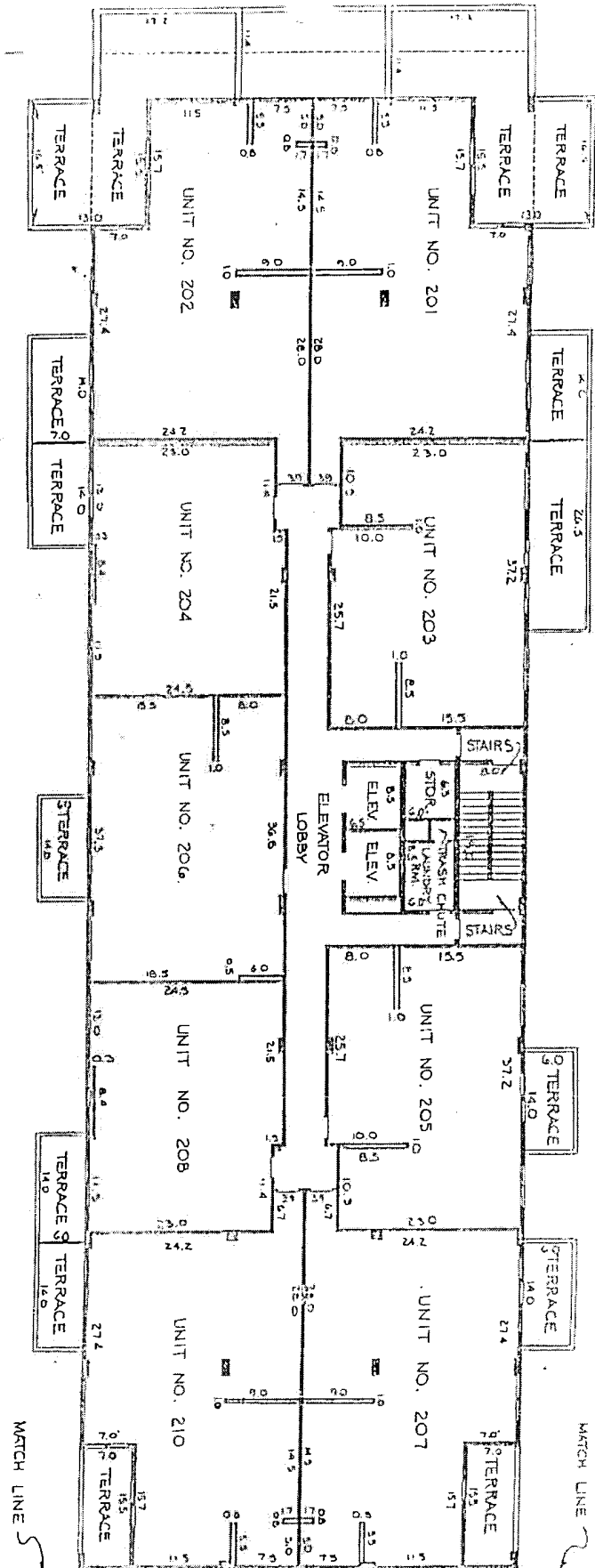
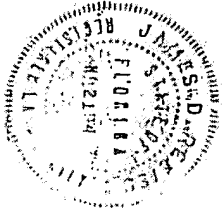

EXHIBIT "7" PLOT PLAN, SURVEY & GRAPHIC DESCRIPTION
THE GEORGIAN CONDOMINIUM
ORDER NO. 80-019 DATE: 10-13-80
ZUBRUELL WHITTAKER INC. REV.: 10-21-80
CONSULTING ENGINEERS & SURVEYORS
MIAMI BEACH, FLORIDA





NOTE: NOT VALID UNLESS RAISED
SEAL OF JAMES D. REEVES, PLS.
NO. 2194, STATE OF FLORIDA IS
AFFIXED.



MEZZANINE FLOOR PLAN (WEST TOWER)

EXHIBIT 'T' PLOT PLAN SURVEY & GRAPHIC DESCRIPTION
THE GEORGIAN CONDOMINIUM
ORDER NO. 80-019
DATE: 10-15-80
ZURWELLE - WHITTAKER, INC.
REV.: 10-27-80
CONSULTING ENGINEERS & SURVEYORS
MIAMI BEACH, FLA.
SHEET 7 OF 29

REC 10944 TO 825

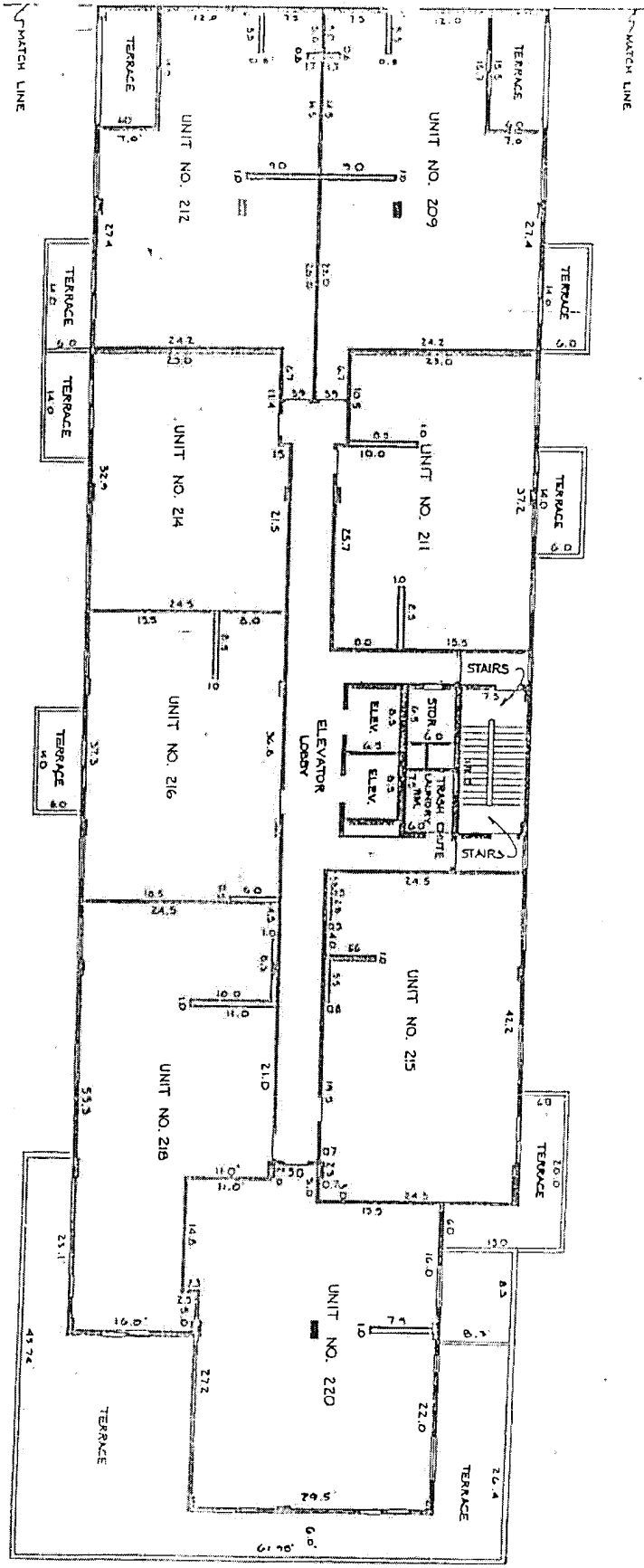

EXHIBIT 'T' PLOT PLAN SURVEY & GRAPHIC DESCRIPTION
THE GEORGIAN CONDOMINIUM
ORDER NO. 60-019
DATE: 10-12-82
ZURWELLE - WHITTAKER, INC.
CONSULTING ENGINEERS & SURVEYORS

NOTE: NOT VALID UNLESS RAISED
SEAL OF JAMES D. REEVES, PLS.
NO. 294, STATE OF FLORIDA IS
REVISED

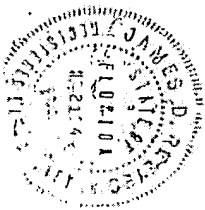
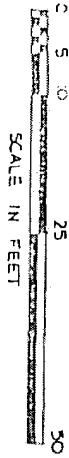
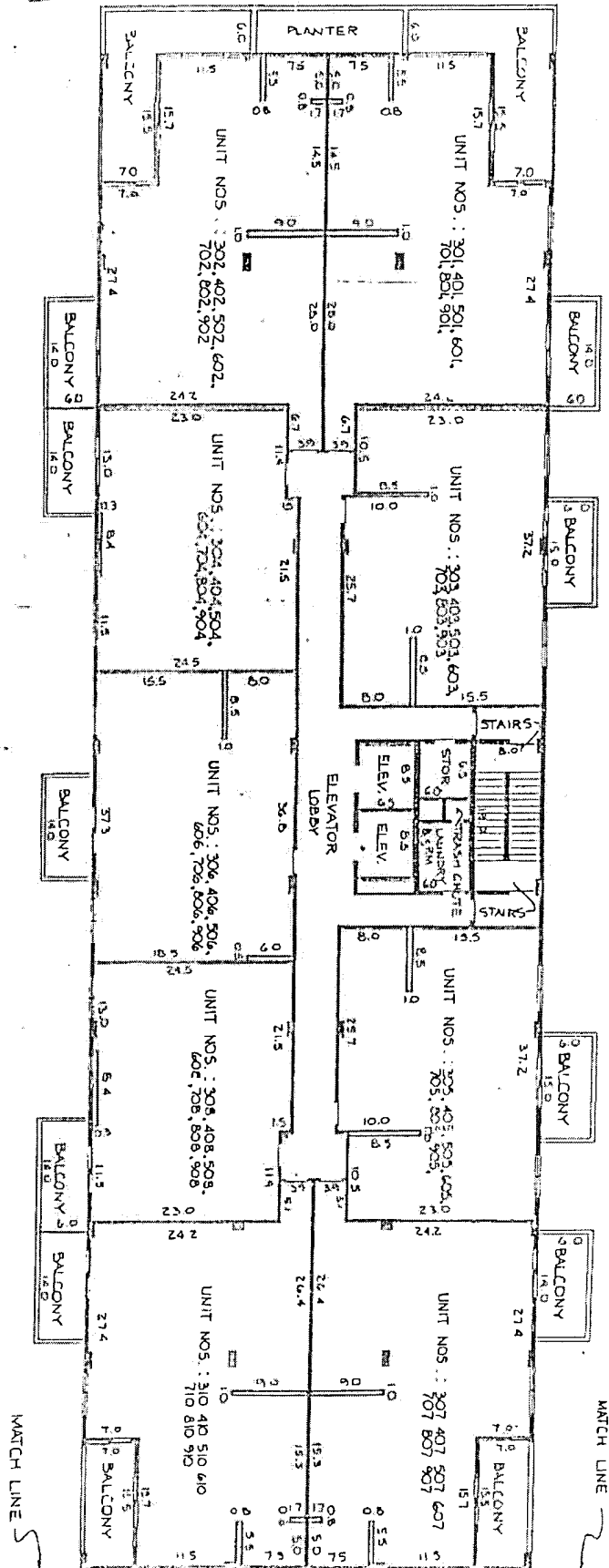
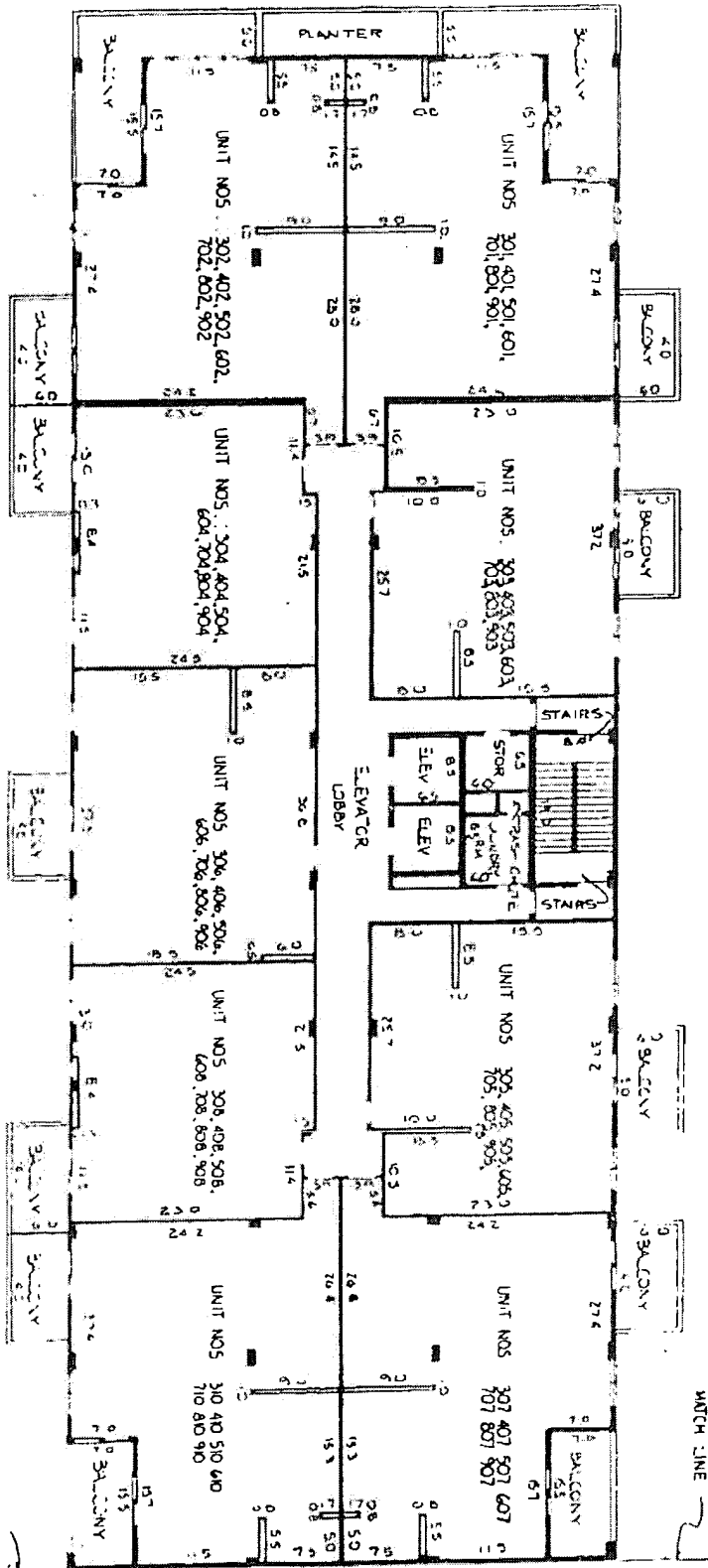

EXHIBIT '7' PLOT PLAN SURVEY & GRAPHIC DESCRIPTION
THE GEORGIAN CONDOMINIUM
ORDER NO. 80-019
ZURVELLE-WHITTAKER, INC.
DATE: 10-13-88
REV: 10-21-88
CONSULTING ENGINEERS & SURVEYORS
JAMES D. REEVES, P.E.

3RD FLOOR PLAN (WEST TOWER)





TYPICAL FLOOR PLAN

(WEST TOWER)

(4th TRRU after FLS)

三、

5
6
7
8
9
10
11
12
13
14
15
16
17
18
19
20
21
22
23
24
25
26
27
28
29
30
31
32
33
34
35
36
37
38
39
40
41
42
43
44
45
46
47
48
49
50
51
52
53
54
55
56
57
58
59
60
61
62
63
64
65
66
67
68
69
70
71
72
73
74
75
76
77
78
79
80
81
82
83
84
85
86
87
88
89
90
91
92
93
94
95
96
97
98
99
100
101
102
103
104
105
106
107
108
109
110
111
112
113
114
115
116
117
118
119
120
121
122
123
124
125
126
127
128
129
130
131
132
133
134
135
136
137
138
139
140
141
142
143
144
145
146
147
148
149
150
151
152
153
154
155
156
157
158
159
160
161
162
163
164
165
166
167
168
169
170
171
172
173
174
175
176
177
178
179
180
181
182
183
184
185
186
187
188
189
190
191
192
193
194
195
196
197
198
199
200
201
202
203
204
205
206
207
208
209
210
211
212
213
214
215
216
217
218
219
220
221
222
223
224
225
226
227
228
229
230
231
232
233
234
235
236
237
238
239
240
241
242
243
244
245
246
247
248
249
250
251
252
253
254
255
256
257
258
259
260
261
262
263
264
265
266
267
268
269
270
271
272
273
274
275
276
277
278
279
280
281
282
283
284
285
286
287
288
289
290
291
292
293
294
295
296
297
298
299
300
301
302
303
304
305
306
307
308
309
310
311
312
313
314
315
316
317
318
319
320
321
322
323
324
325
326
327
328
329
330
331
332
333
334
335
336
337
338
339
340
341
342
343
344
345
346
347
348
349
350
351
352
353
354
355
356
357
358
359
360
361
362
363
364
365
366
367
368
369
370
371
372
373
374
375
376
377
378
379
380
381
382
383
384
385
386
387
388
389
390
391
392
393
394
395
396
397
398
399
400
401
402
403
404
405
406
407
408
409
410
411
412
413
414
415
416
417
418
419
420
421
422
423
424
425
426
427
428
429
430
431
432
433
434
435
436
437
438
439
440
441
442
443
444
445
446
447
448
449
450
451
452
453
454
455
456
457
458
459
460
461
462
463
464
465
466
467
468
469
470
471
472
473
474
475
476
477
478
479
480
481
482
483
484
485
486
487
488
489
490
491
492
493
494
495
496
497
498
499
500
501
502
503
504
505
506
507
508
509
510
511
512
513
514
515
516
517
518
519
520
521
522
523
524
525
526
527
528
529
530
531
532
533
534
535
536
537
538
539
540
541
542
543
544
545
546
547
548
549
550
551
552
553
554
555
556
557
558
559
560
561
562
563
564
565
566
567
568
569
570
571
572
573
574
575
576
577
578
579
580
581
582
583
584
585
586
587
588
589
590
591
592
593
594
595
596
597
598
599
600
601
602
603
604
605
606
607
608
609
610
611
612
613
614
615
616
617
618
619
620
621
622
623
624
625
626
627
628
629
630
631
632
633
634
635
636
637
638
639
640
641
642
643
644
645
646
647
648
649
650
651
652
653
654
655
656
657
658
659
660
661
662
663
664
665
666
667
668
669
670
671
672
673
674
675
676
677
678
679
680
681
682
683
684
685
686
687
688
689
690
691
692
693
694
695
696
697
698
699
700
701
702
703
704
705
706
707
708
709
710
711
712
713
714
715
716
717
718
719
720
721
722
723
724
725
726
727
728
729
730
731
732
733
734
735
736
737
738
739
740
741
742
743
744
745
746
747
748
749
750
751
752
753
754
755
756
757
758
759
760
761
762
763
764
765
766
767
768
769
770
771
772
773
774
775
776
777
778
779
780
781
782
783
784
785
786
787
788
789
790
791
792
793
794
795
796
797
798
799
800
801
802
803
804
805
806
807
808
809
810
811
812
813
814
815
816
817
818
819
820
821
822
823
824
825
826
827
828
829
830
831
832
833
834
835
836
837
838
839
840
841
842
843

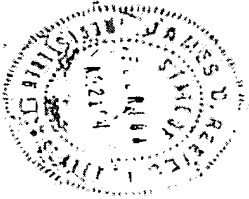
[illegible]

ELEVATION PLAN, SLOPE & GRAPHIC DESCRIPTION
 — GEORGIA CONDOMINIUM —
 CHASE NO. 650A
 TUCKERVILLE AVENUE, INC.
 CONSULTING ENGINEERS & SURVEYORS
 PALM BEACH, FLA.
 DATE: 06/03/80
 REV 10/21/80
 SHEET 10 OF 29

NOTE: NOT VALID UNLESS BASED
SEAL OF JAMES D. REEVES, P.L.S.
NO. 2194 STATE OF FLORIDA IS
AFFIXED

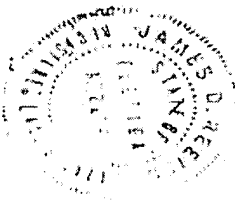
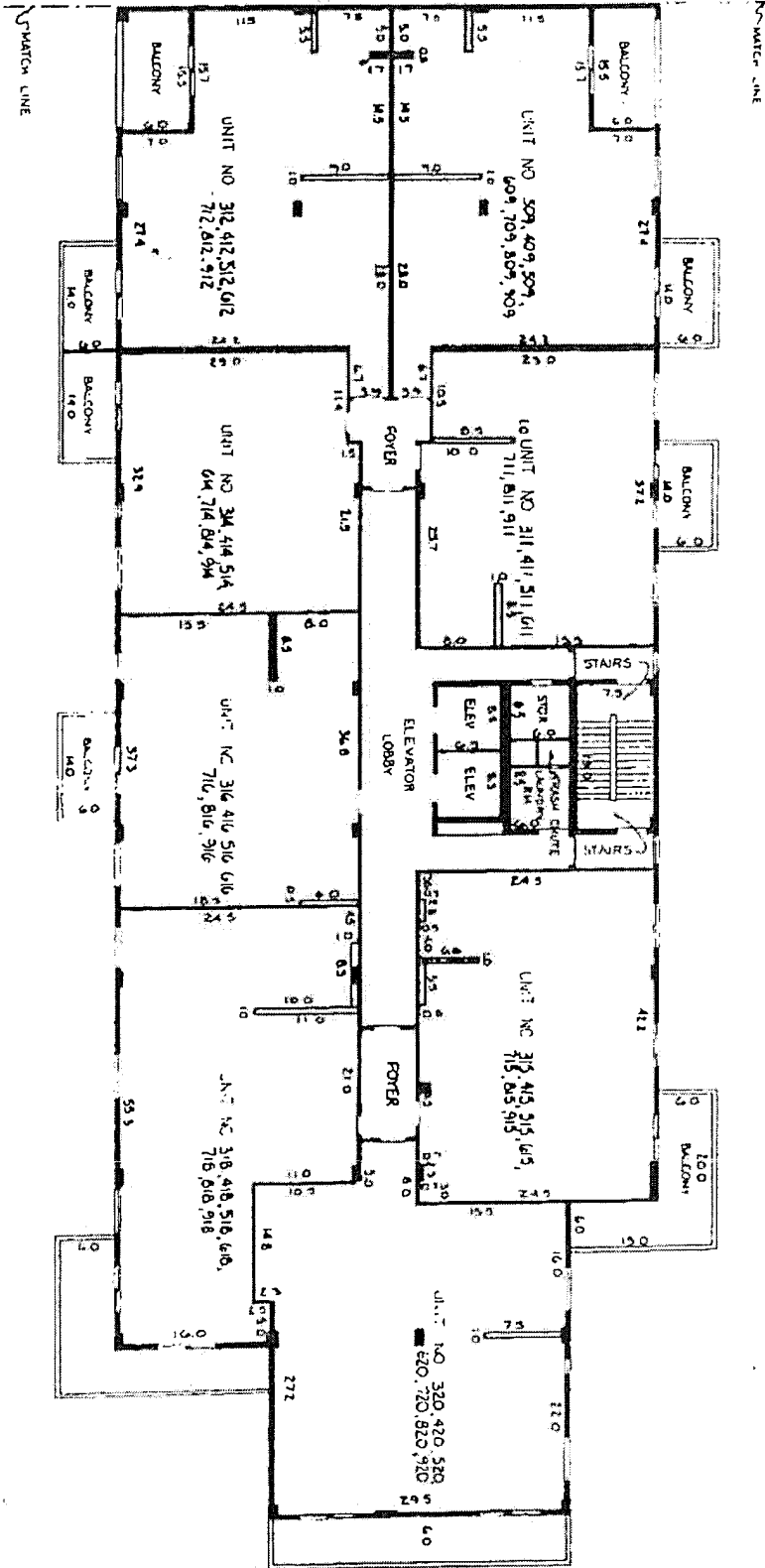
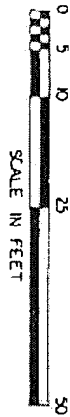

EXHIBIT "T" PLOT PLAN SURVEY & GRAPHIC DESCRIPTION
THE GEORGIAN CONDOMINIUM
ORDER NO. 80-08
DATE: 10-15-80
ZURWELLE-WHITTAKER, INC.
CONSULTING ENGINEERS & SURVEYORS
MIAMI BEACH, FLORIDA
SHEET 11 OF 29

TYPICAL FLOOR PLAN
(EAST TOWER)



10944 829

NOTE: NOT VALID UNLESS RAISED
SEAL OF JAMES D. REEVES, PLS.
NO. 294, STATE OF FLORIDA IS
AFFIXED.

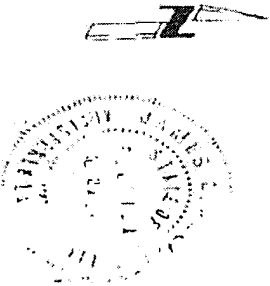
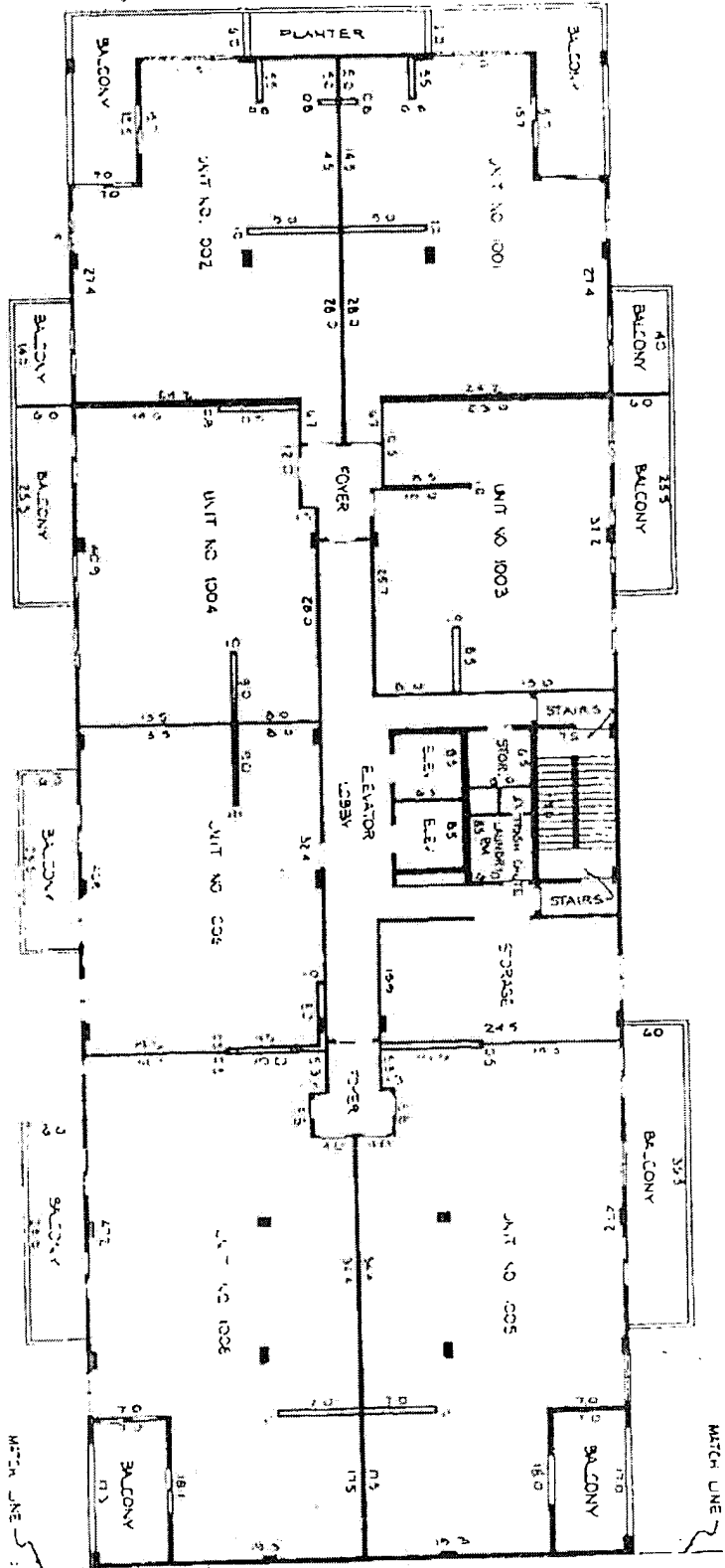
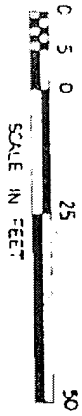

PENTHOUSE FLOOR PLAN (WEST TOWER)

ENCLOSURE - 2007 PLAN SURVEY & GRAPHIC DESCRIPTION
THE GEORGIAN CONDOMINIUM
ORDER NO. BC-019 DATE: 10/13/80
ZURWELLE-WHITTAKER, INC. REV. 10/21/80
CONSULTING ENGINEERS & SURVEYORS
MAY, BEACH, FLA.
SHEET 12 OF 29

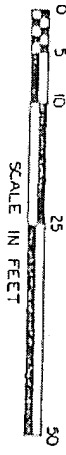
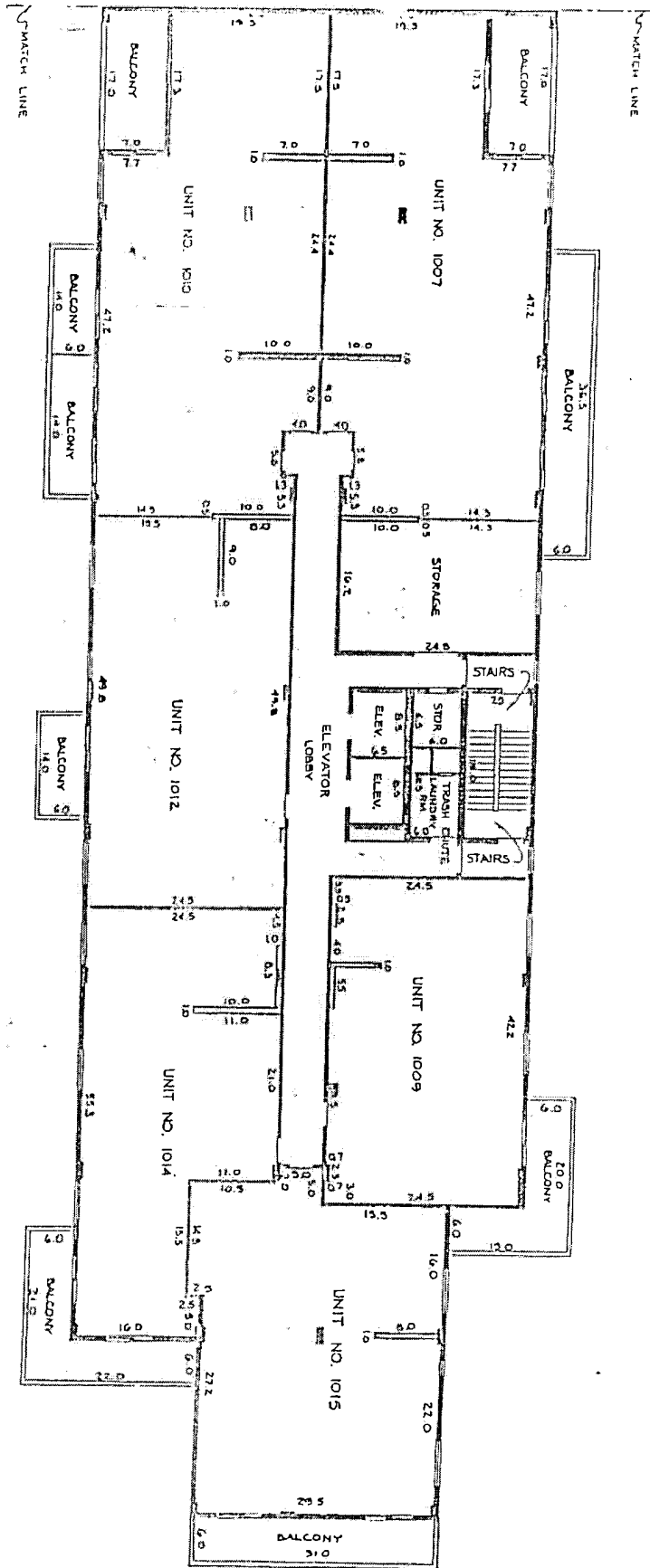

NOTE: NOT VALID UNLESS RAISED
SEAL OF JAMES D. REYES, PLS
NO 2194 STATE OF FLORIDA IS
AFFIXED

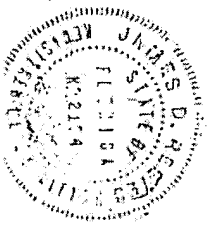

PENTHOUSE FLOOR PLAN
(EAST TOWER)

EXHIBIT '7' PLOT PLAN SURVEY & GRAPHIC DESCRIPTION
THE GEORGIAN CONDOMINIUM
ORDER NO. 80-014
ZURWELLE - WHITTAKER, INC.
CONSULTING ENGINEERS & SURVEYORS
MIAMI BEACH, FLORIDA
DATE: 10-17-80
REV: 10-21-80
SHEET 14 OF 24

Architectural floor plan of a building with two wings. The plan includes dimensions for various sections and overall lengths.

Left Wing Dimensions (from top to bottom):

- Overall length: 20.4
- Section 1: 21.3
- Section 2: 21.3
- Section 3: 5.3
- Section 4: 51.2
- Section 5: 14.0
- Section 6: 30.8
- Section 7: 28.0
- Section 8: 30.3
- Section 9: 28.9
- Section 10: 5.3
- Section 11: 2.1
- Section 12: 2.1
- Section 13: 27.2
- Section 14: 20.0
- Section 15: 4.3
- Section 16: 29.6

Right Wing Dimensions (from top to bottom):

- Overall length: 20.2
- Section 1: 5.3
- Section 2: 34.0
- Section 3: 17.0
- Section 4: 52.5
- Section 5: 21.0
- Section 6: 24.8
- Section 7: 14.1
- Section 8: 21.0
- Section 9: 21.3
- Section 10: 21.3
- Section 11: 20.4
- Section 12: 5.3
- Section 13: 51.2
- Section 14: 14.0
- Section 15: 30.8
- Section 16: 28.0
- Section 17: 30.3
- Section 18: 28.9
- Section 19: 5.3
- Section 20: 2.1
- Section 21: 2.1
- Section 22: 27.2
- Section 23: 20.0
- Section 24: 4.3
- Section 25: 29.6

Internal Features and Dimensions:

- Left Wing:** ROOF WALK, ELEV. WALK, 18.0
- Right Wing:** ROOF WALK, ELEV. WALK, 17.0

SCALE IN FEET

NOTE: NOT VALID UNLESS RAISED
SEAL OF JAMES D REEVES, PL.A
NO. 2194. STATE OF FLORIDA IS
AFFIXED.

RECEIVED
JAMES D. REED
FLORIDA
MAY 21 1964

ROOF PLAN

EXHIBIT "F" FLOOR PLAN SURVEY & GEOTECH DESCRIPTION
THE GEORGIAN CONDOMINIUM
ORDER NO. 00-019
ZIMWELLE, WHITTAKER, INC.
CONSULTING ENGINEERS & SURVEYORS
MIAMI BEACH, FLORIDA
DATE: 10-15-88
REV.: 10-21-88
SHEET 14 OF 29

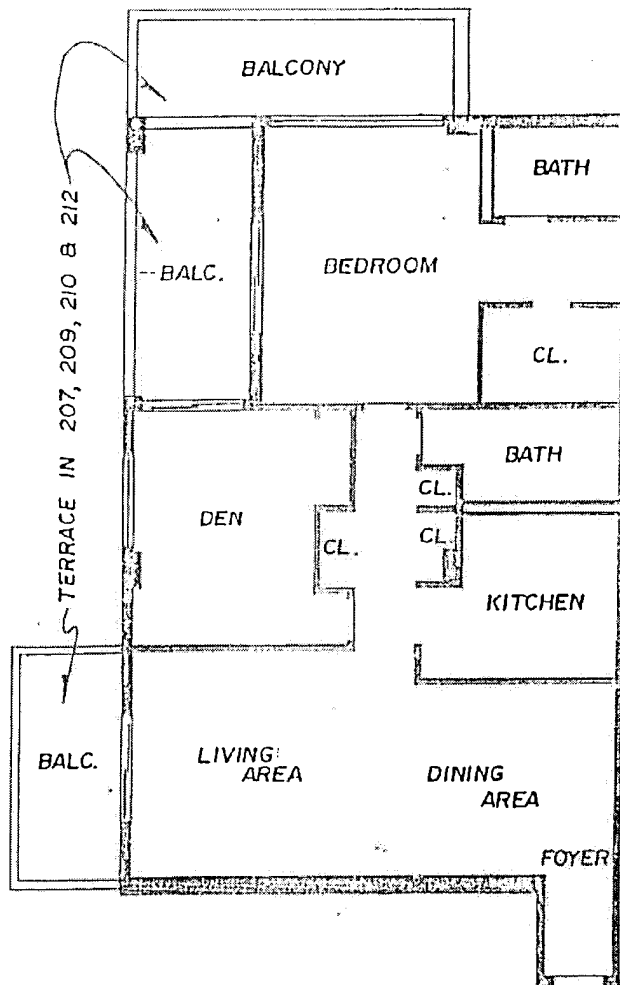

TYPE "A"

UNIT NOS.: 301, 401, 501, 601, 701, 801, 901, 1001,
302, 402, 502, 602, 702, 802, 902, 1002,
207, 307, 407, 507, 607, 707, 807, 907,
209, 309, 409, 509, 609, 709, 809, 909,
210, 310, 410, 510, 610, 710, 810, 910,
212, 312, 412, 512, 612, 712, 812, 912.

EXHIBIT "7"

THE GEORGIAN CONDOMINIUM

ORDER NO. 80-019
ZURWELLE - WHITTAKER, INC.
CONSULTING ENGINEERS & SURVEYORS
MIAMI BEACH, FLORIDA

DATE: 10-13-80
REV.: 10-21-80

SHEET 15 OF 29

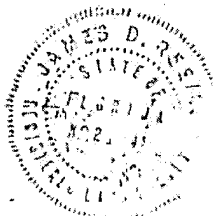

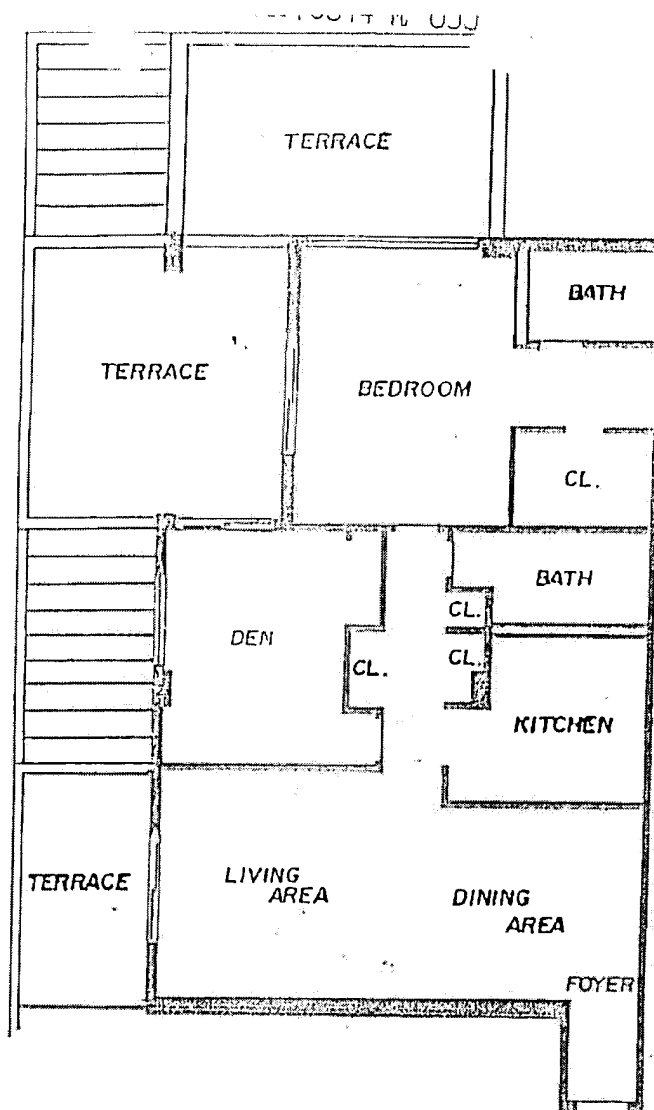

TYPE "A-1"
UNIT NOS. : 201, 202.

EXHIBIT "7"

THE GEORGIAN CONDOMINIUM

ORDER NO. 80-019

ZURWELLE - WHITTAKER, INC.

CONSULTING ENGINEERS & SURVEYORS

MIAMI BEACH, FLORIDA

DATE: 10-13-80

REV.: 10-21-80

SHEET 16 OF 29

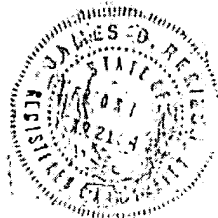

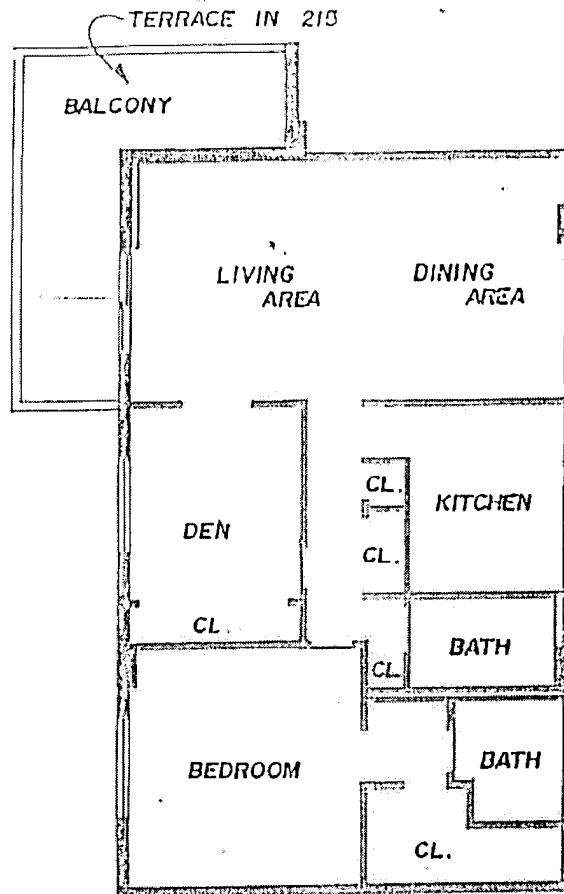

TYPE "B"

UNIT NOS.: 215, 315, 415, 515, 615, 715, 815, 915, 1009.

EXHIBIT "7"

THE GEORGIAN CONDOMINIUM

ORDER NO. 80-019

ZURWELLE - WHITTAKER, INC.

CONSULTING ENGINEERS & SURVEYORS

MIAMI BEACH, FLORIDA

DATE: 10-13-80

REV.: 10-21-80

SHEET 17 OF 29



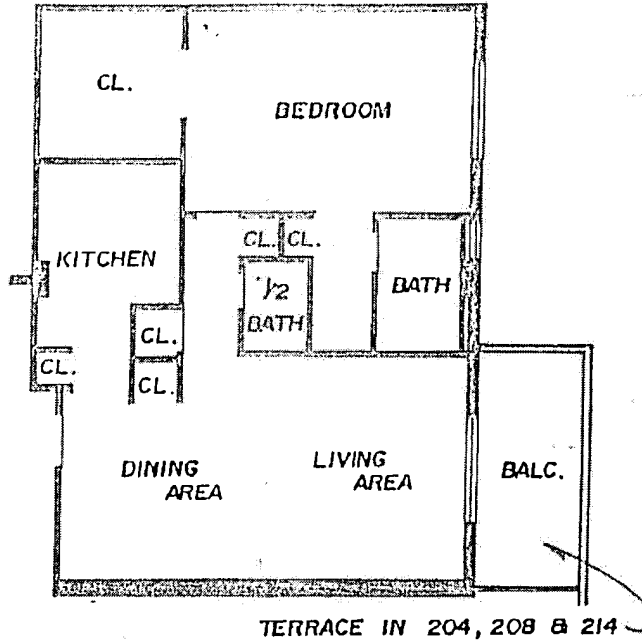

TYPE "C"

UNIT NOS.: 204, 304, 404, 504, 604, 704, 804, 904,
208, 308, 408, 508, 608, 708, 808, 908,
214, 314, 414, 514, 614, 714, 814, 914.

EXHIBIT "7"

THE GEORGIAN CONDOMINIUM

ORDER NO. 80-019

ZURWELLE - WHITTAKER, INC.

CONSULTING ENGINEERS & SURVEYORS

MIAMI BEACH, FLORIDA

DATE: 10-13-80

REV.: 10-21-80

SHEET 18 OF 29



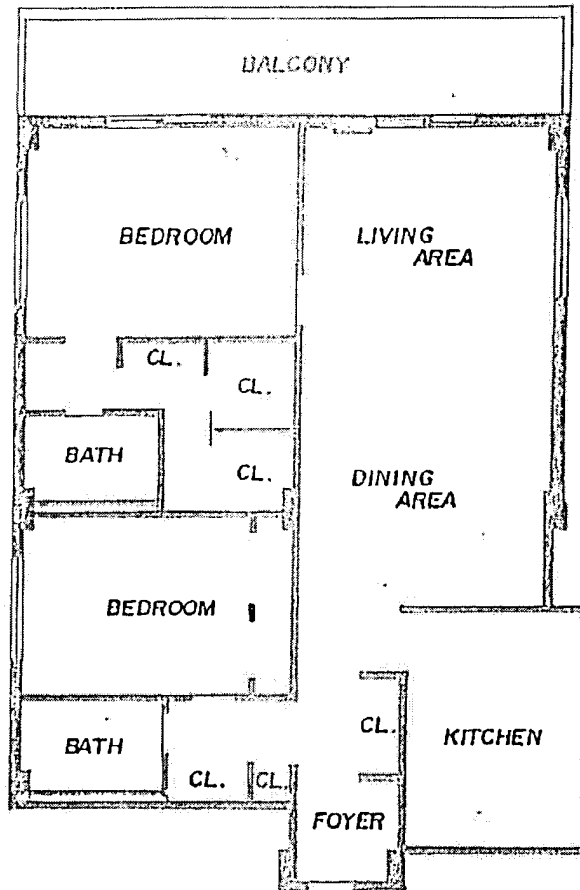

TYPE "D"

UNIT NOS.: 320, 420, 520, 620, 720, 820, 920, 1015.

EXHIBIT "7"

THE GEORGIAN CONDOMINIUM

ORDER NO. 80-019

ZURWELLE - WHITTAKER, INC.

CONSULTING ENGINEERS & SURVEYORS

MIAMI BEACH, FLORIDA

DATE: 10-13-80

REV.: 10-21-80

SHEET 19 OF 29

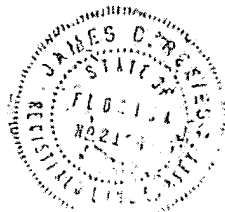

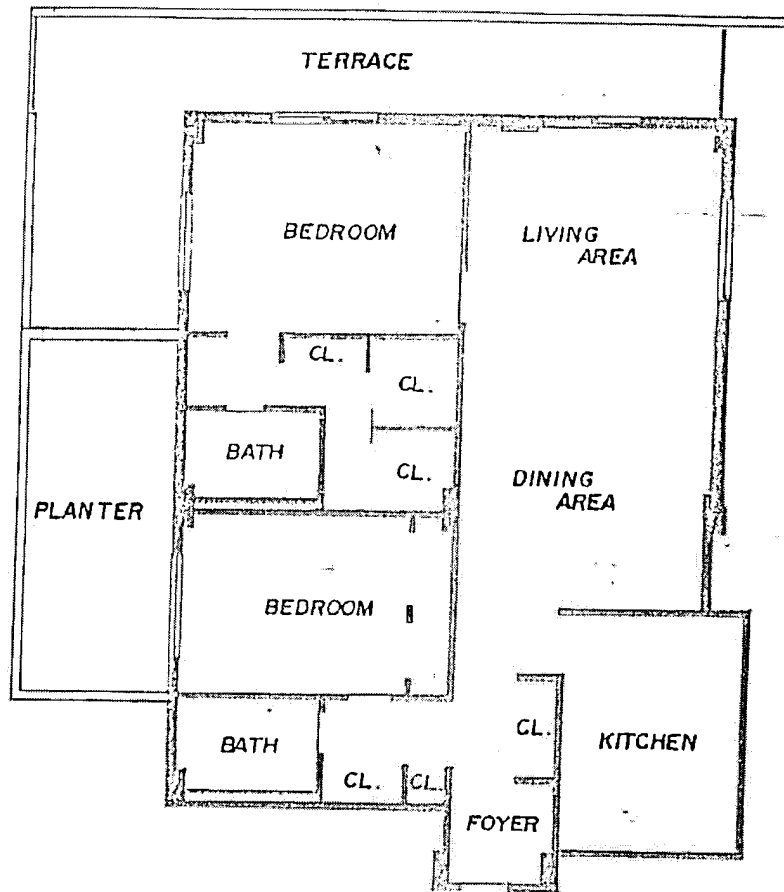

TYPE "D-1"
UNIT NOS ... 220

EXHIBIT "7"

THE GEORGIAN CONDOMINIUM

ORDER NO 80-019

ZURWELLE - WHITTAKER, INC.

CONSULTING ENGINEERS & SURVEYORS

MIAMI BEACH, FLORIDA

DATE: 10-13-80

REV: 10-21-80

SHEET 20 OF 29



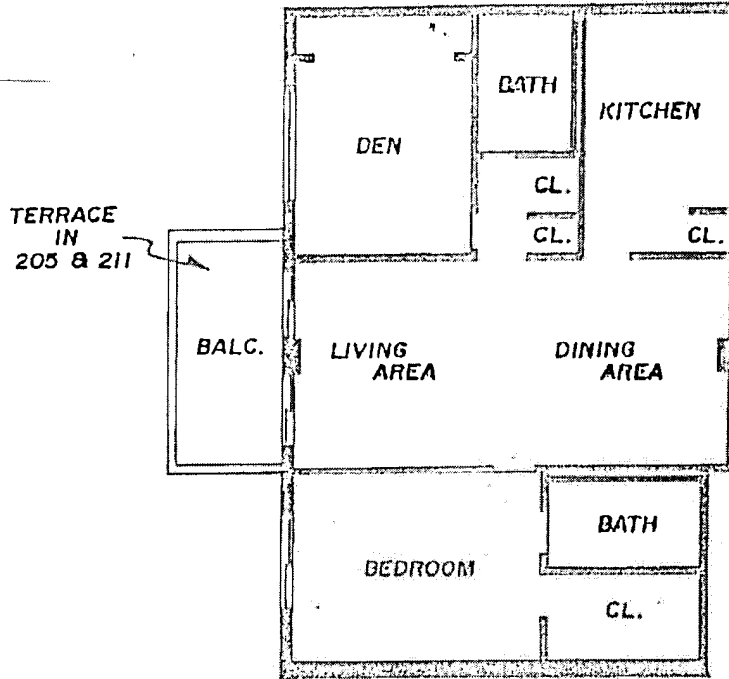

TYPE "E"

UNIT NOS : 303, 403, 503, 603, 703, 803, 903,
205, 305, 405, 505, 605, 705, 805, 905,
211, 311, 411, 511, 611, 711, 811, 911.

EXHIBIT "7"

THE GEORGIAN CONDOMINIUM

ORDER NO. 80-019

ZURWELLE - WHITTAKER, INC.

CONSULTING ENGINEERS & SURVEYORS

MIAMI BEACH, FLORIDA

DATE: 10-13-80

REV.: 10-21-80

SHEET 21 OF 29



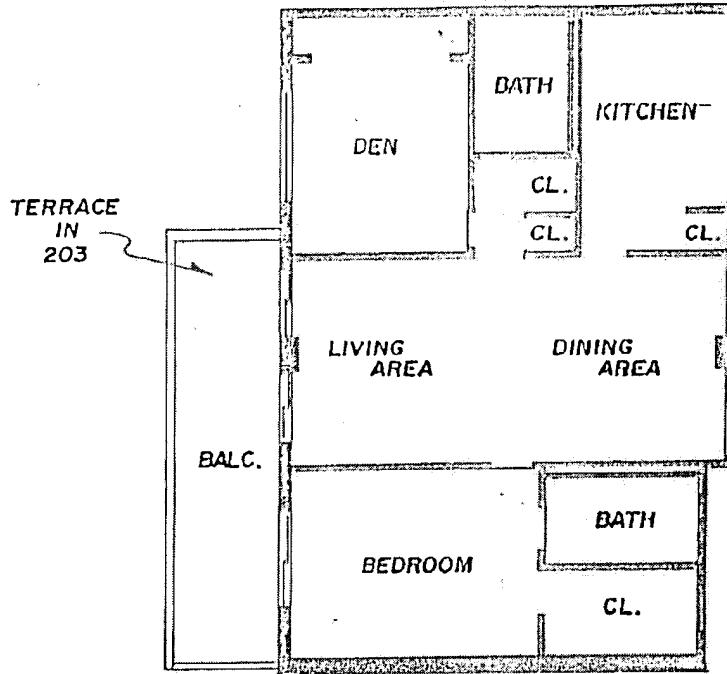

TYPE "E-1"
UNIT NOS.: 203, 1003.

EXHIBIT "7"

THE GEORGIAN CONDOMINIUM

ORDER NO. 80-019
ZURWELLE - WHITTAKER, INC.
CONSULTING ENGINEERS & SURVEYORS
MIAMI BEACH, FLORIDA

DATE: 10-13-80
REV.: 10-21-80

SHEET 22 OF 29

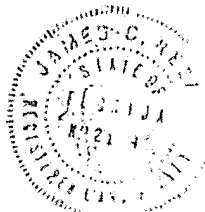

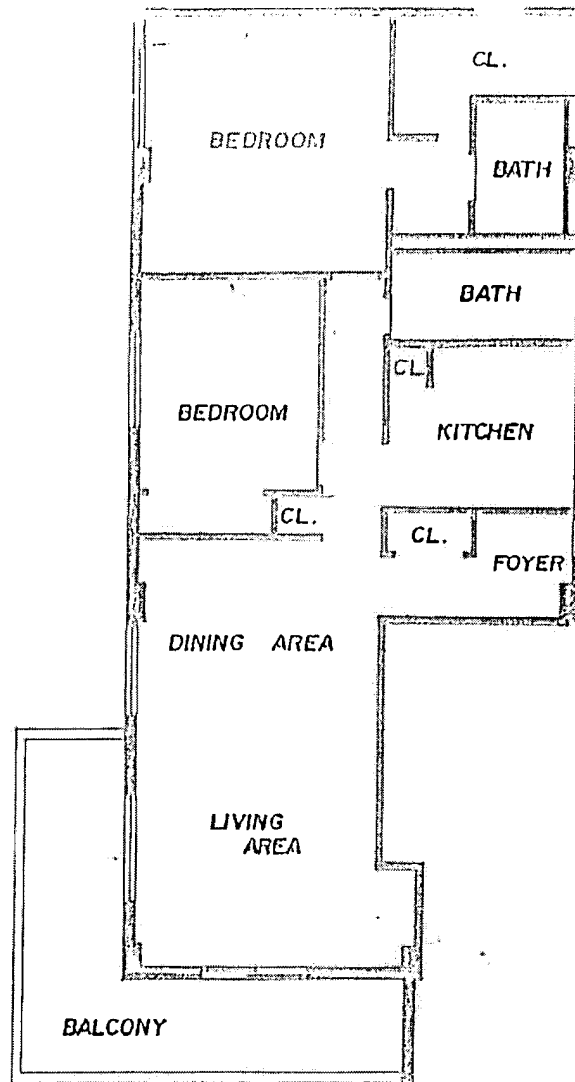

TYPE "F"

UNIT NOS. 318, 418, 518, 618, 718, 818, 918, 1014.

EXHIBIT "7"

THE GEORGIAN CONDOMINIUM

ORDER NO. 80-019

DATE: 10-13-80

ZURWELLE - WHITTAKER, INC.

REV.: 10-21-80

CONSULTING ENGINEERS & SURVEYORS

MIAMI BEACH, FLORIDA

SHEET 23 OF 29

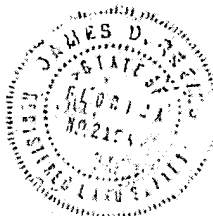

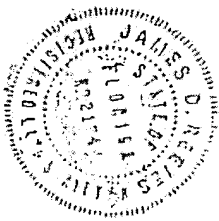
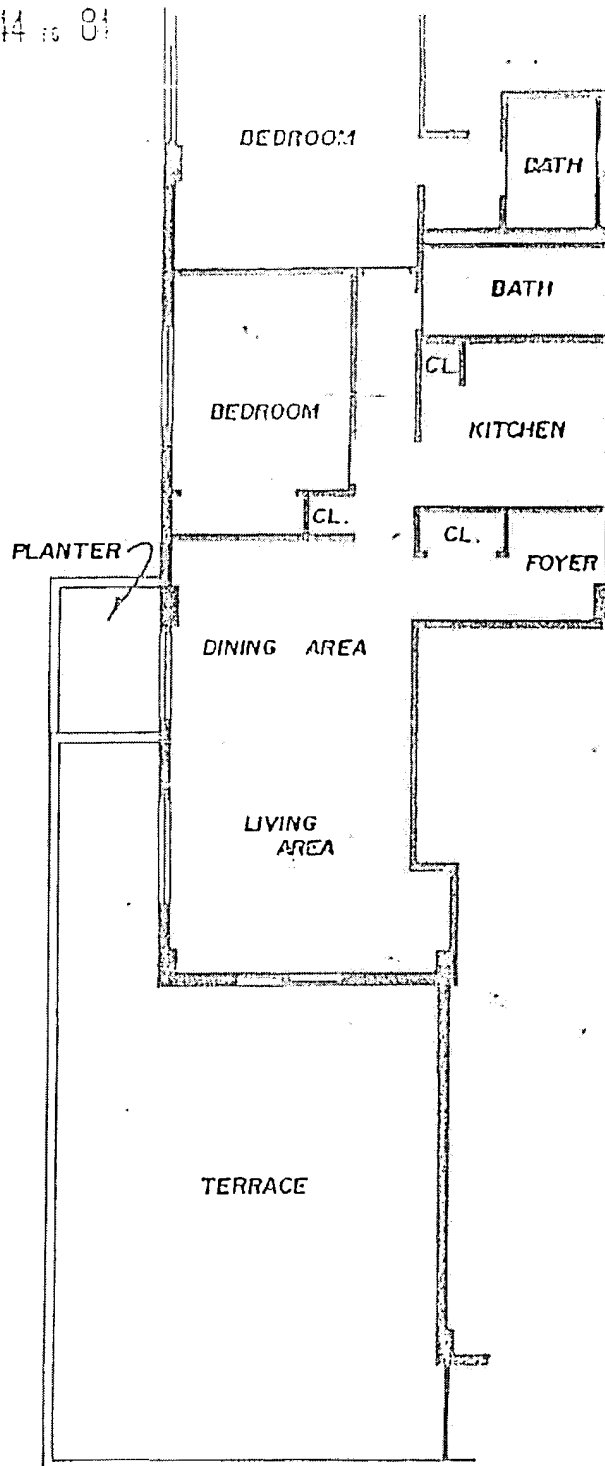

TYPE "F-1"

UNIT NO. 218

UNIT NO. 218

THE GEORGIAN CONDOMINIUM

RECORD NO. PG-019

PREPARED BY WHITTAKER, INC.

REGISTERED ENGINEERS & SURVEYORS

NO. 10-13-80

DATE 10-13-80

REV. 10-21-80

SHEET 24 OF 29

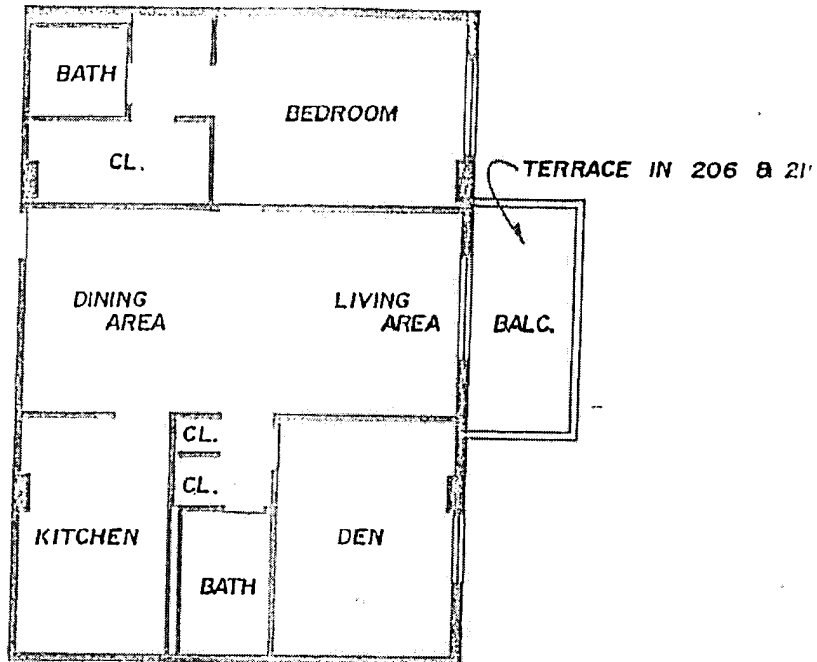

TYPE "G"

UNIT NOS.: 206, 306, 406, 506, 606, 706, 806, 906,
216, 316, 416, 516, 616, 716, 816, 916.

EXHIBIT "7"

THE GEORGIAN CONDOMINIUM

ORDER NO. 80-019

ZURWELLE - WHITTAKER, INC.

CONSULTING ENGINEERS & SURVEYORS

MIAMI BEACH, FLORIDA

DATE: 10-13-80

REV.: 10-21-80

SHEET 25 OF 29

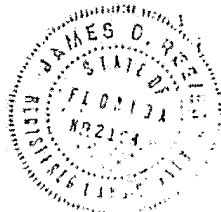

REC 10944 PG 843

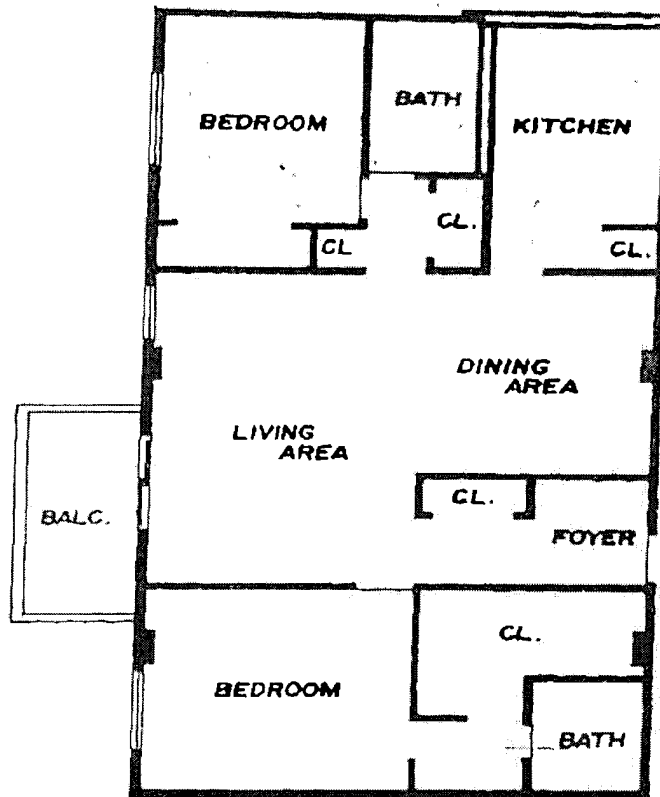

TYPE "H"
UNIT NOS 1012

EXHIBIT "7"

THE GEORGIAN CONDOMINIUM

ORDER NO 80-019

ZURWELLE - WHITTAKER, INC.

CONSULTING ENGINEERS & SURVEYORS

MIAMI BEACH, FLORIDA

DATE: 10-13-80

REV.: 10-21-80

SHEET 26 OF 29



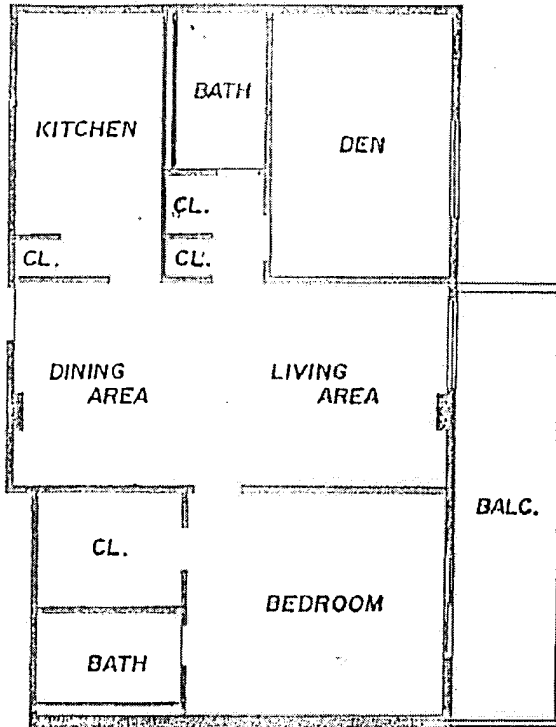

TYPE "1"
UNIT NOS.: 1004

EXHIBIT "7"

THE GEORGIAN CONDOMINIUM

ORDER NO. 80-019

ZURWELLE - WHITTAKER, INC.

CONSULTING ENGINEERS & SURVEYORS

MIAMI BEACH, FLORIDA

DATE: 10-13-80

REV.: 10-21-80

SHEET 27 OF 29



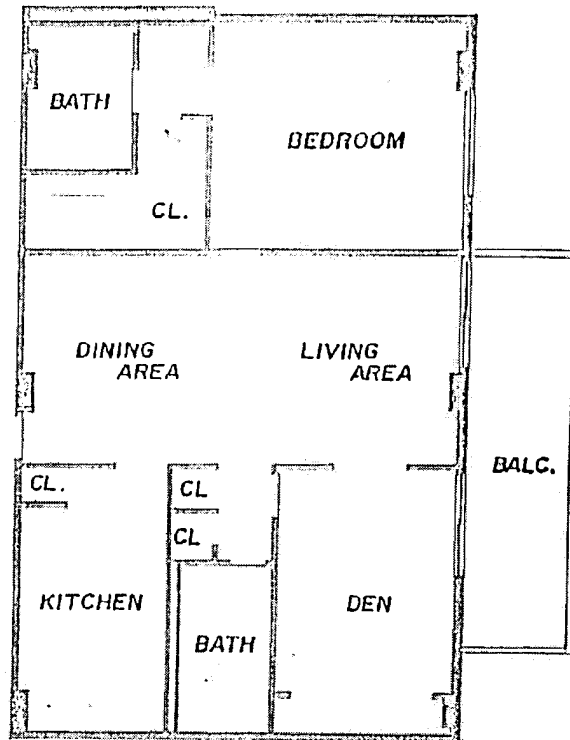

TYPE "J"
UNIT NOS.: 1006

EXHIBIT "7"

THE GEORGIAN CONDOMINIUM

ORDER NO. 80-019

ZURWELLE - WHITTAKER, INC.

CONSULTING ENGINEERS & SURVEYORS

MIAMI BEACH, FLORIDA

DATE: 10-13-80

REV.: 10-21-80

SHEET 28 OF 29



REC'D 10-13-80

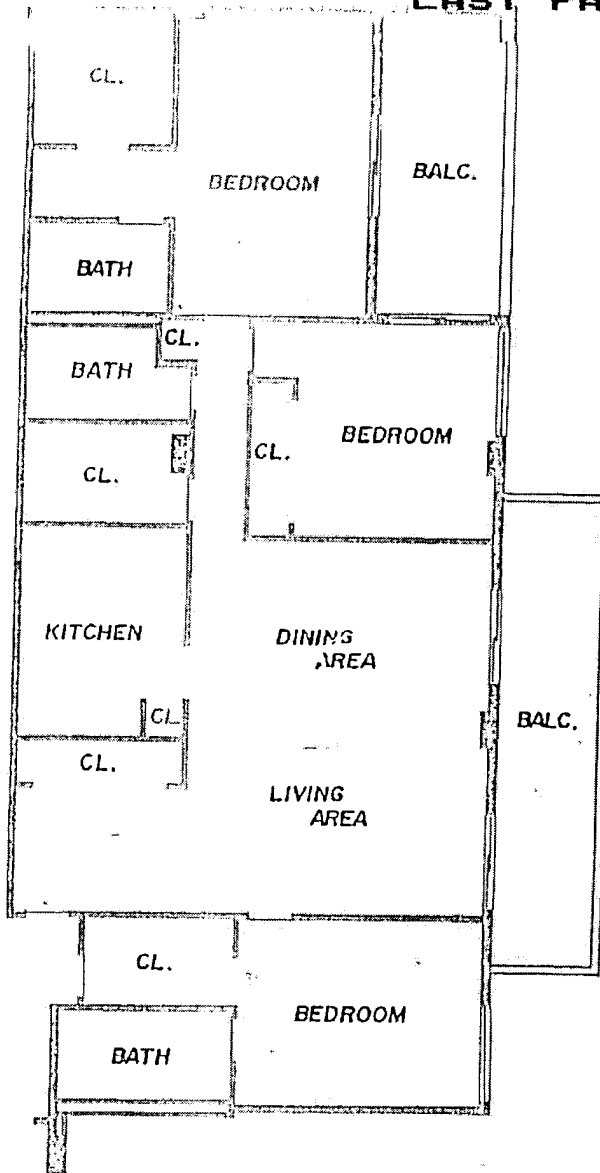

CLERK NOTE:
FOR CONDOMINIUM PLANS SEE OFFICIAL
RECORDS CONDOMINIUM PLANS BK. 113 PAGE 5

BY: Richard P. Brinker CLERK
CIRCUIT & COUNTY COURT
D.C.

TYPE "K"
UNIT NOS.: 1005, 1007, 1008, 1010

EXHIBIT "7"

THE GEORGIAN CONDOMINIUM

ORDER NO. 80-019

ZURWELLE - WHITTAKER, INC.

CONSULTING ENGINEERS & SURVEYORS

MIAMI BEACH, FLORIDA

DATE: 10-13-80

REV.: 10-21-80

SHEET 29 OF 29

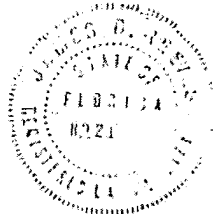

RECORDED IN OFFICIAL RECORDS BOOK
OF DADE COUNTY, FLORIDA.
RECORD VERIFIED
RICHARD P. BRINKER,
CLERK CIRCUIT COURT